

SPECIFICATIONS

Storm Sewers:

All work shall be performed in accord with these Plans and Specifications and requirements of the Ohio Environmental Protection Agency and the current Specifications of the City of Napoleon, Ohio, Engineering Department, Rules and Regulations, Ordinance No. 1715.

Excess excavated material shall be placed where directed by the ENGINEER. Existing utilities indicated on the Plans are based on available information and are not guaranteed by the ENGINEER for accuracy of completeness. Any work to be performed in the area of existing utilities shall require prior notice to the utility owner.

Specifications for Storm pipe and fittings shall be:

| Pipe Material | Material Spec. | Joint Spec. |
|--------------------------|------------------|-------------|
| Reinforced Concrete | ASTM C-76 | C-443 |
| PVC (Polyvinyl Chloride) | ASTM 3034 SDR 35 | D-3212 |
| PERMA-Loc or Equal | ASTM 2412 | D-3212 |

Corrugated Polyethylene Pipe shall be of high density polyethylene corrugated pipe with smooth liner and shall meet the requirements of O. D. O. T. Supplemental Specification 944, except the pipe shall have a minimum pipe stiffness of 46 psi. & 5% deflection when tested in accordance with ASTM D2412. Couplings shall have gaskets of closed cell expanded rubber or neoprene.

Storm sewer shall be bedded and backfilled with #57 ODOT Specification material placed in layers not to exceed six (6) inches compacted thickness. It is the intent of these Specifications to not excavate any more additional slope than what is necessary to bed the pipe, in addition to allowing equipment to gain access for construction.

All earth embankment will be compacted to ninety-five percent (95%) of standard proctor with lifts no greater than eight inches (8") in thickness.

Compensation for all items of work shall be based on the unit price bid for the specified unit and shall include, but not be limited to all materials, supplies, labor, equipment and other items required to complete said item. Compensation for work required for which no unit price is provided shall be included in other items of work and no additional compensation shall be allowed therefore.

GENERAL NOTES

- CONTRACTOR SHALL PLACE TOPSOIL AND REGRADE ALL DISTURBED LAWN AREAS. ALL SUCH AREAS NOT MARKED FOR LANDSCAPING SHALL BE SEEDED, FERTILIZED AND MULCHED BY THE CONTRACTOR. LANDSCAPING NOTED WILL BE BY OTHERS.
- ALL DIRECTIONAL SIGNAGE WILL BE BY OTHERS.
- ALL STORM SEWER TRENCHES SHALL BE BACKFILLED WITH WELL COMPACTED GRANULAR MATERIAL TO WITHIN 8" OF THE FINISHED GRADE IN LAWN AND LANDSCAPE AREAS OR TO THE BOTTOM OF DRIVEWAY OR SIDEWALK PAVEMENT.
- ALL CONCRETE SHALL BE MINIMUM 6 BAG MIX, 3000 PSI. COMPRESSIVE STRENGTH AT 28 DAYS.
- PREFABRICATED MEDIAN CURB SHALL BE 6" INTER-LOCK CURB AS MANUFACTURED BY MINNICK CONCRETE PRODUCTS, INC., FORT WAYNE, INDIANA, OR EQUAL.
- ASPHALT PAVEMENT SEALER SHALL BE BY JENNITE, OR EQUAL.
- ITEM 202 STRUCTURES REMOVED SHALL INCLUDE THE REMOVAL OF ALL CURB, SIDEWALK AND PAVEMENT, ETC. REQUIRED BY THE CONSTRUCTION AS WELL AS THE REMOVAL OF THE HOUSE AND GARAGE.

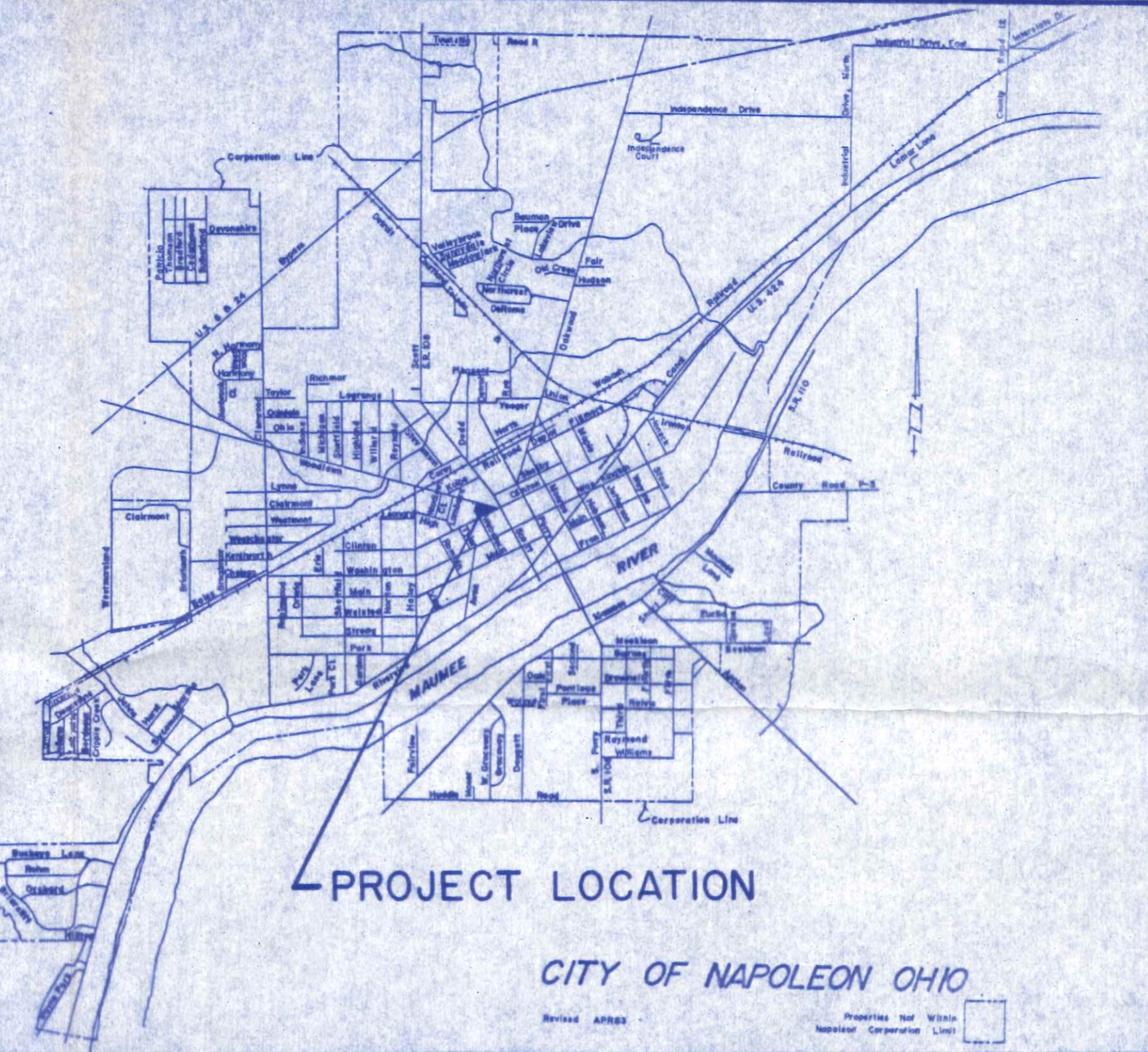
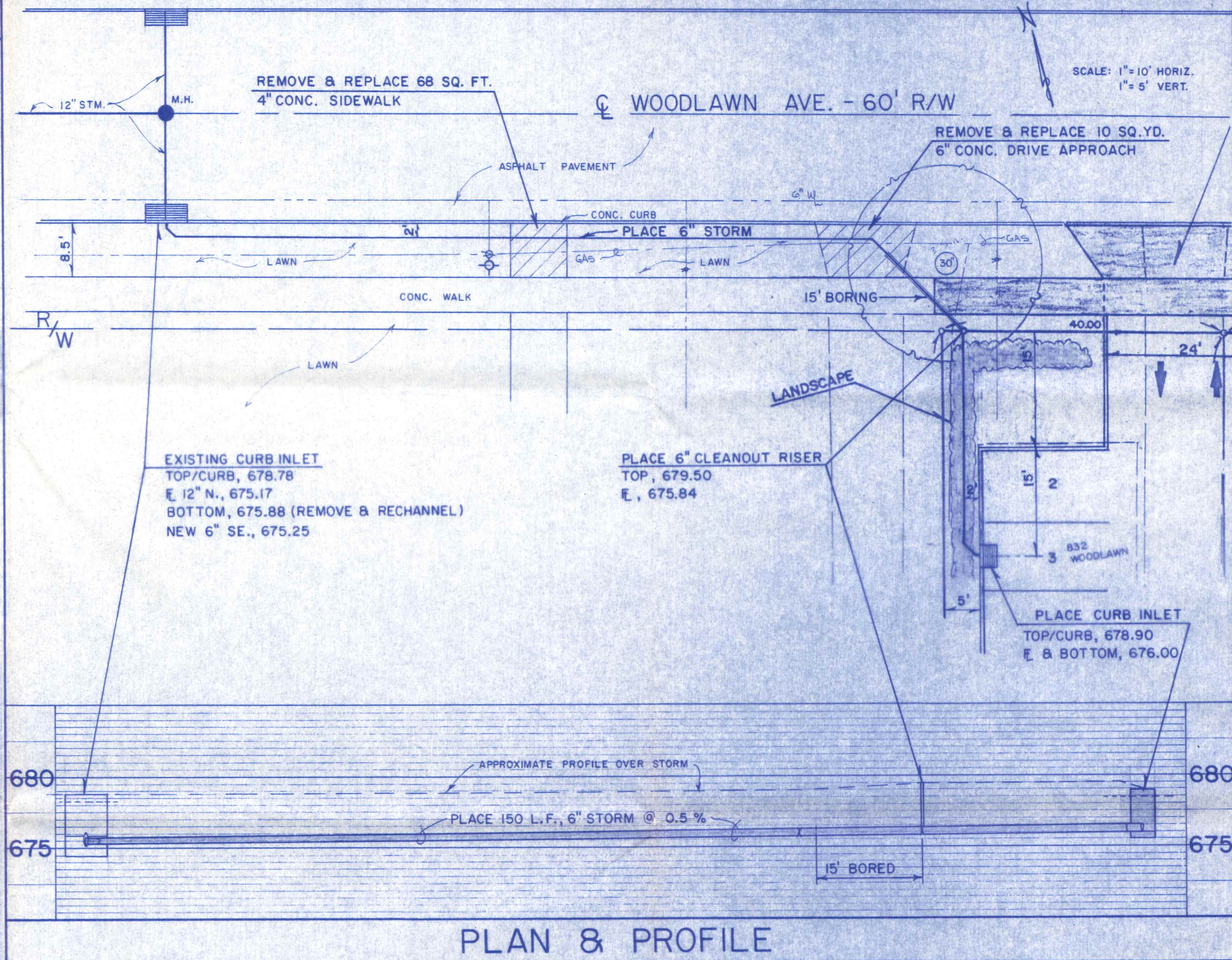

LOCATION MAP

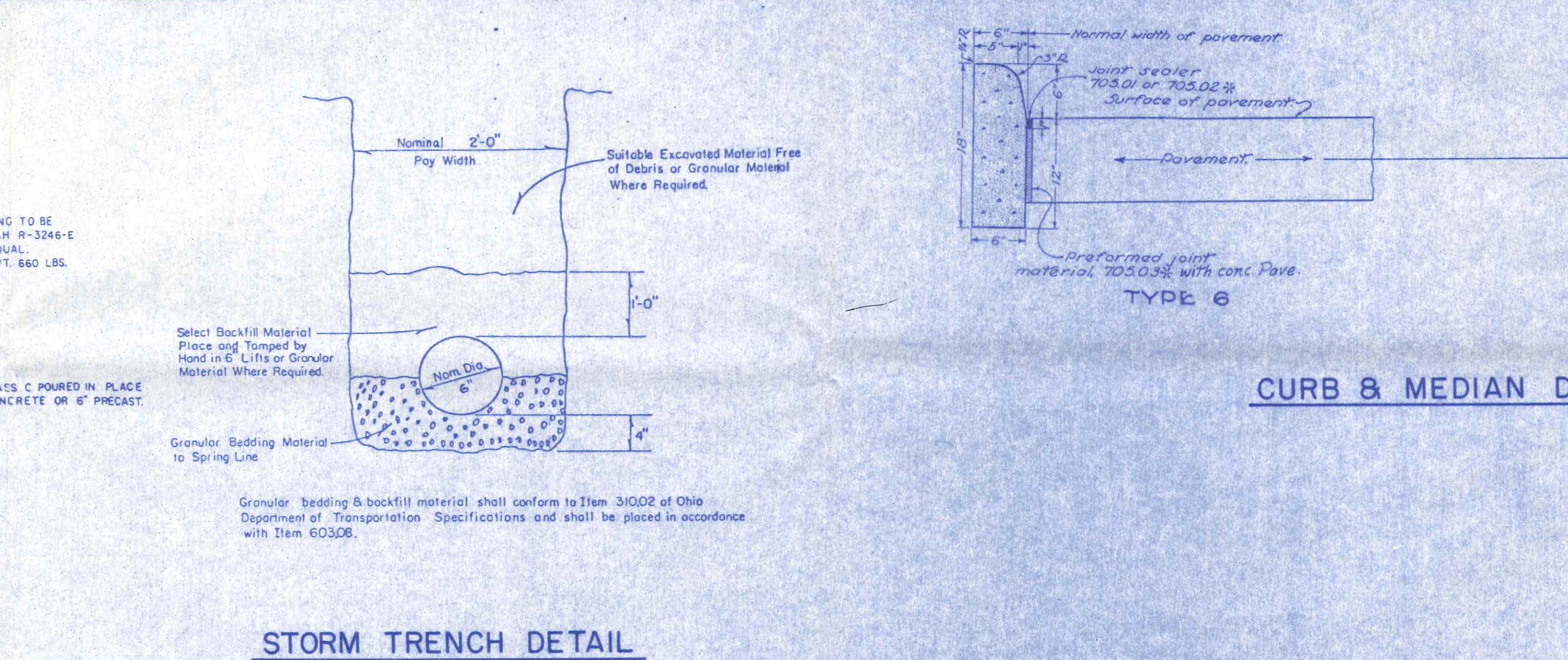

CURB & MEDIAN DETAILS

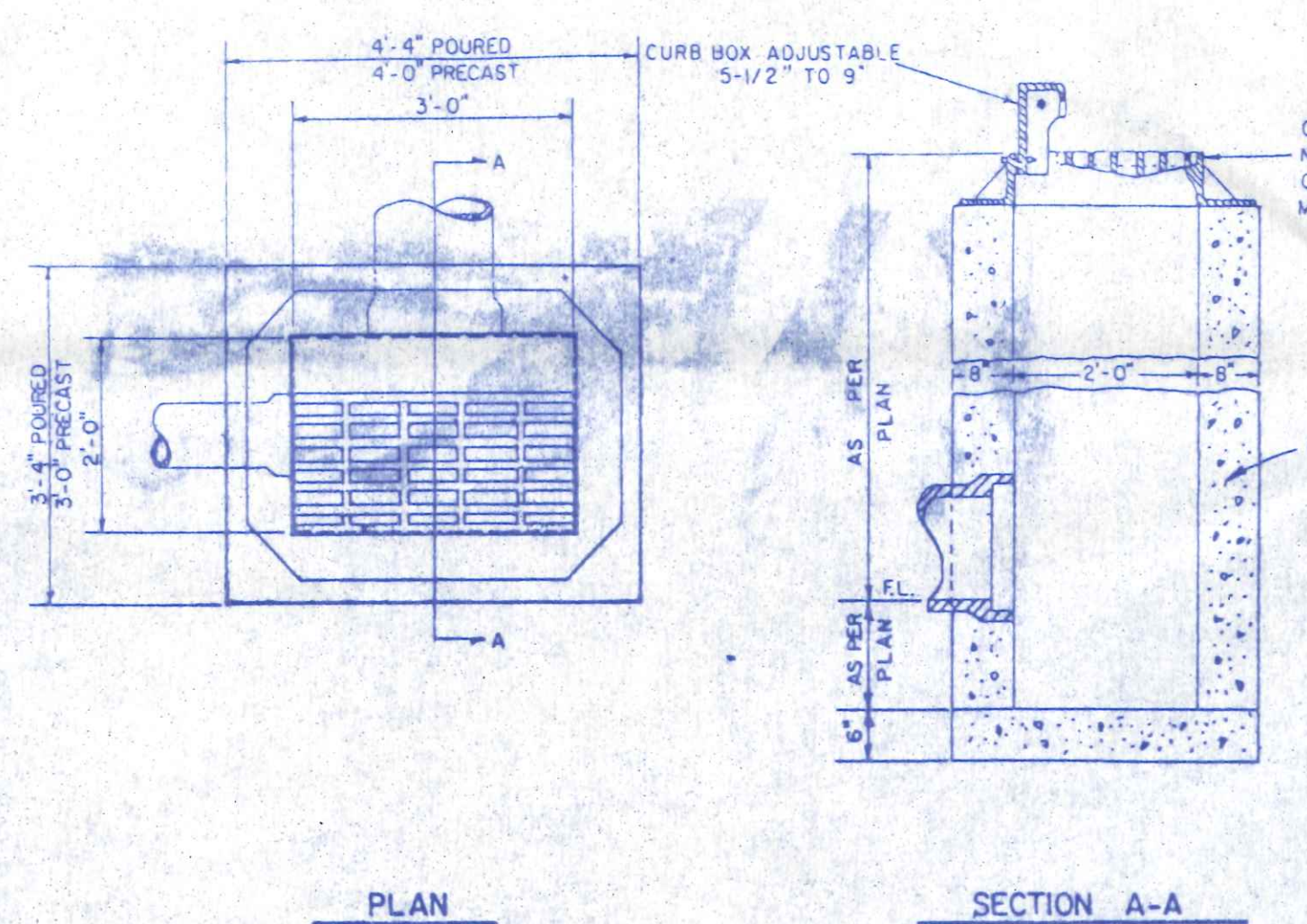

CURB INLET DETAIL

STORM TRENCH DETAIL

220 W. Clinton

| | |
|---|---------------------|
| FIRST NATIONAL BANK OF NORTHWEST OHIO WOODLAWN AVE. & CLINTON ST. NAPOLEON, OHIO | |
| SCALE: NOTED | APPROVED BY: R.D.S. |
| DATE: AUG. 92 | REVISED: |
| DRIVE-THRU & PARKING LOT IMPROVEMENTS | |
| DRAWING NO.: S-1 | |

REVISED 7-8-93, OMT PLS. SPACE #1, R.D.S.

PARKING CRITERIA

| | |
|-------------------------|----|
| PARKING SPACES EXISTING | 24 |
| PARKING SPACES PROPOSED | 34 |
| PARKING SPACES REQUIRED | 21 |

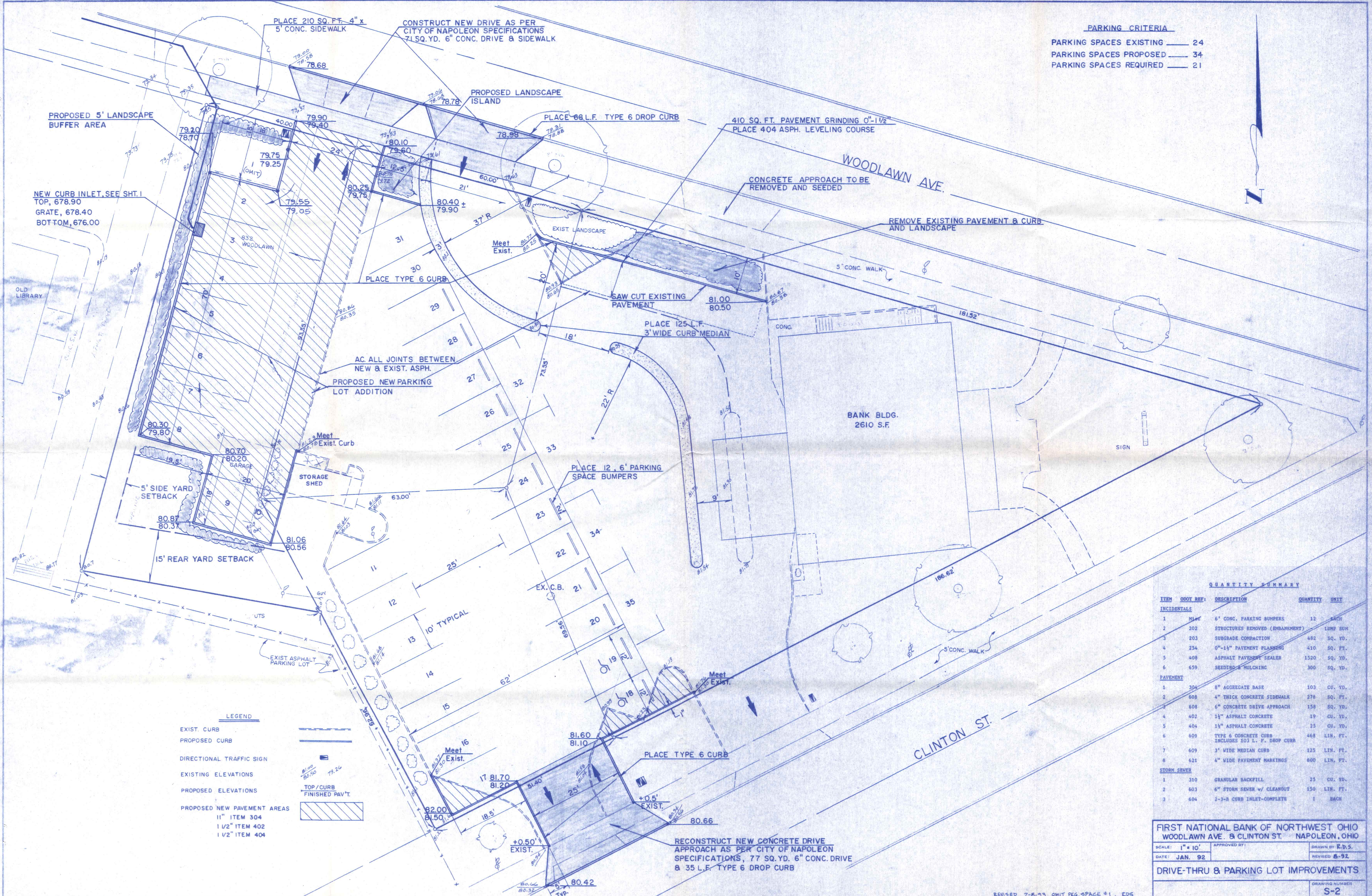

LEGEND

| | |
|-----------------------------|----------------|
| EXIST. CURB | --- |
| PROPOSED CURB | --- |
| DIRECTIONAL TRAFFIC SIGN | ⬆ |
| EXISTING ELEVATIONS | 81.00 80.50 |
| PROPOSED ELEVATIONS | 79.26 |
| PROPOSED NEW PAVEMENT AREAS | ▨ |
| 1" ITEM 304 | |
| 1 1/2" ITEM 402 | |
| 1 1/2" ITEM 404 | |

QUANTITY SUMMARY

| ITEM | QTY | REF. | DESCRIPTION | QUANTITY | UNIT |
|--------------------|------|------|--|----------|----------|
| INCIDENTALS | | | | | |
| 1 | 12 | MISC | 6" CONC. PARKING BUMPERS | 12 | EACH |
| 2 | | 202 | STRUCTURES REMOVED (EMBANKMENT) | | LUMP SUM |
| 3 | 482 | 203 | SUBGRADE COMPACTION | 482 | SQ. YD. |
| 4 | 410 | 234 | 0"-1 1/2" PAVEMENT PLANNING | 410 | SQ. FT. |
| 5 | 1320 | 408 | ASPHALT PAVEMENT SEALER | 1320 | SQ. YD. |
| 6 | 300 | 659 | SEEDING & MULCHING | 300 | SQ. YD. |
| PAVEMENT | | | | | |
| 1 | 103 | 304 | 8" AGGREGATE BASE | 103 | CU. YD. |
| 2 | 276 | 608 | 4" THICK CONCRETE SIDEWALK | 276 | SQ. FT. |
| 3 | 158 | 608 | 6" CONCRETE DRIVE APPROACH | 158 | SQ. YD. |
| 4 | 19 | 402 | 1 1/2" ASPHALT CONCRETE | 19 | CU. YD. |
| 5 | 25 | 404 | 1 1/2" ASPHALT CONCRETE | 25 | CU. YD. |
| 6 | 468 | 609 | TYPE 6 CONCRETE CURB INCLUDES 103 L. F. DROP CURB | 468 | LIN. FT. |
| 7 | 125 | 609 | 3' WIDE MEDIAN CURB | 125 | LIN. FT. |
| 8 | 600 | 621 | 4" WIDE PAVEMENT MARKINGS | 600 | LIN. FT. |
| STORM SEWER | | | | | |
| 1 | 25 | 310 | GRANULAR BACKFILL | 25 | CU. YD. |
| 2 | 150 | 603 | 6" STORM SEWER w/ CLEANOUT | 150 | LIN. FT. |
| 3 | 1 | 604 | 2-3-R CURB INLET-COMplete | 1 | BACK |

FIRST NATIONAL BANK OF NORTHWEST OHIO
WOODLAWN AVE. & CLINTON ST. NAPOLEON, OHIO

SCALE: 1" = 10' APPROVED BY: _____ DRAWN BY: E.D.S.
DATE: JAN. 92 REVISIONS: _____ REVISED 6-92

DRIVE-THRU & PARKING LOT IMPROVEMENTS

DRAWING NUMBER: _____
S-2